

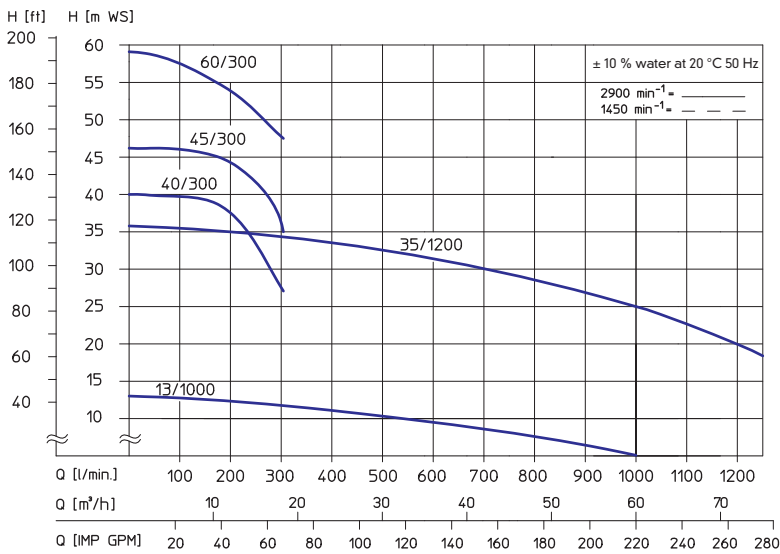

- Delivery rate up to 1.250 l/min
- Delivery head up to 60 m wc
- No shaft seal required
- For aggressive and neutral liquids
- Made of PP or PVDF
- Protection class IP 55

Magnetically coupled centrifugal pumps of type 5 are non-self-priming pumps that operate in horizontal position and are made in monobloc design. A magnetic coupling connects the pump to the motor and transmits the power of the motor to the impeller.

### PERFORMANCE CHARTS



### STANDARD DESIGN

Housing, impeller and impeller magnet coating are made of glass-fibre reinforced PP plastic or PVDF. Sleeve bearings, starting rings and centering shaft are made of 99.7% pure oxide ceramic, and the O-ring sealing of the housing is made of either FKM or EPDM. (See table on page 7 for other materials.)

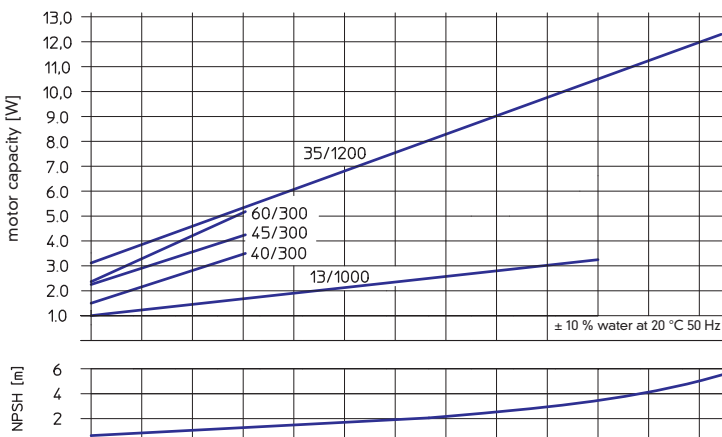



# NON-SELF-PRIMING RM – TYPE 5

## TECHNICAL DATA

size	40/300	45/300	60/300	13/1000		35/1200
maximum delivery rate [l/min]	300	300	300	1000		1250
maximum delivery head [m wc]	40	45	60	13		35
maximum density [g/cm <sup>3</sup> ] <sup>***</sup>	0.9	1.0	1.1	1.25	1.6	1.1
motor capacity a 50 Hz [kW]	3.0	4.0	5.5	4.0	5.5	12.5
motor capacity a 60 Hz [kW]	3.6	4.8	6.6	4.8	6.6	15.0
current rating (400 V) [A]	6.25	8.1	11.0	8.1	11.0	24.0
rated speed at 50 Hz [min <sup>-1</sup> ]	2900	2900	2900	1450	1450	2900
rated speed at 60 Hz [min <sup>-1</sup> ]	3440	3440	3440	1750	1750	3440
ports suction side	G2 3/4	G2 3/4	G2 3/4	FF d110	FF d110	FF d110
ports discharge side	G2 1/4	G2 1/4	G2 1/4	FF d90	FF d90	FF d90
weight when made of PP approx. [kg]	49	53	57	51	61	80
weight when made of PVDF approx. [kg]	56	60	66	52	69	90
dimension A [mm]	619	625	692	680	740	780
dimension H [mm]	316	316	331	-	-	-
dimension D [mm]	194	220	250	220	250	260

voltage**	230 V ac or 230/400 V three-phase current	
protection class	hose-proof according to IP 55	
recommended maximum flow rate	suction side 1 m/s	discharge side 3 m/s
material	PP	PVDF
maximum temperature	80 °C	95 °C
maximum system pressure at 20 °C	6.0 bar	6.0 bar

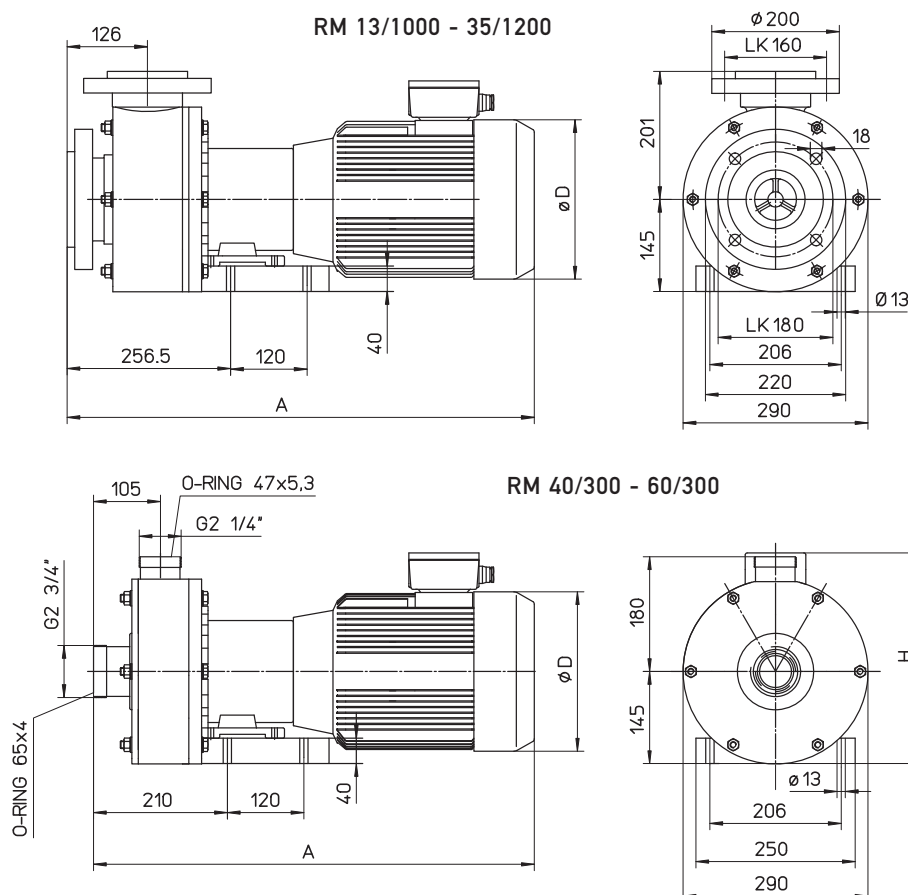

\*\* Other voltages available upon request.  
 \*\*\* With maximum volume rate of flow. To deliver liquids with a higher relative density, the pump has to be throttled (see the following performance chart).

Position of the terminal box: standard position is on top (if you need it mounted on the right or the left, please indicate when placing your order).  
 Position of the discharge port: vertical position is standard (differing positions at 12 x 30° are possible, please indicate when placing your order).